

# A1 Series



Designed to leave the guide pin, which eliminates the use of longer pins and bushes, which can be costly.

Ball cage is designed to circulate around pin and bush, giving even wear and longer life.

A1 Series are completely interchangeable with all popular mass produced pin and bush assemblies.

A1 Series can be fitted into Hales standard die set without any modification.

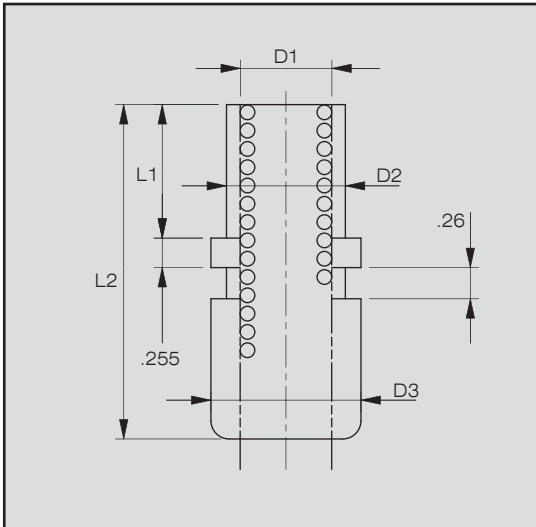

A1 SERIES PIN BUSH AND CAGE ASSEMBLY

HALES BUSH NO.	D1	D2		D3	D4	L1	L2
		HOLE	BUSH				
		+0 +.0010	+.0002 +0				
A1-1"	1.274	1.500	1.875	2.275	1.218	3.437	
A1-1.25"	1.524	1.750	2.125	2.525	1.218	3.937	
A1-1.5"	1.774	2.000	2.375	2.775	1.437	4.187	

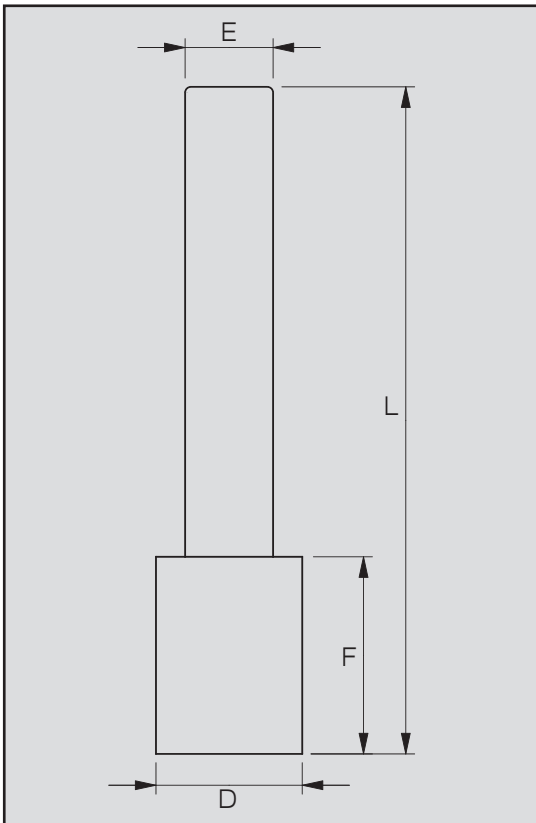

NOM PIN DIA	D	E	F	L
	+0.0000	+0.0000	+0.020	+0.030
	-0.0002	-0.0002		-0.000
1"	.9855	.900	1.250	4.5, 5.75, 6.5, 7, 7.5, 8
1.25"	1.2355	1.150	1.500	5.75, 6.5, 7, 7.5, 8, 8.5
1.5"	1.4855	1.400	1.500	6, 6.5, 7, 7.5, 8, 8.5, 9.5